

**NOTES**  
ALL DIMENSIONS MUST BE VERIFIED ON SITE AND ANY DISCREPANCIES REPORTED TO TDSB BEFORE PROCEEDING WITH WORK.  
ALL DRAWINGS AND SPECIFICATIONS ARE INSTRUMENTS OF SERVICE AND THE PROPERTY OF TDSB AND MUST BE RETURNED AT THE COMPLETION OF THE WORK.  
DO NOT SCALE FROM DRAWING

**KEY PLAN**

**LEGAL DESCRIPTION**  
PROPERTY ASSESSMENT NOTICE - 2003  
MIDDLESEX CENTRE TOWNSHIP  
15237 THIRTEEN MILE RD.  
CON 12 PT LOT 9  
FRONTAGE - 825.00  
DEPTH -  
AREA - 10.06 AC

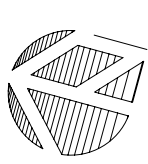
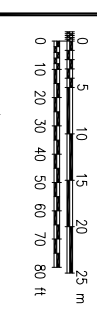

**SITE NOTES**

**SITE INFORMATION**  
ADDRESS - LONDON ONTARIO  
LEGAL DESCRIPTION - REGISTERED PLAN NO. 2 IN THE DISTRICT OF MIDDLESEX COUNTY OF MIDDLESEX  
GROSS SITE AREA - 3 SQM / 2 ha  
GROSS BUILDING AREA - EXISTING BUILDING = 2 SQM. PORTABLES = 2 SQM. TOTAL = 4 SQM.  
PARKING AREA - 2 SQM.  
BUILDING COVERAGE - REQUIRED max.: 2%. PROVIDED: 2%  
LANDSCAPED OPEN AREA - REQUIRED min.: 2%. PROVIDED: 2%  
PARKING - REQUIRED: 1 SPACE PER CLASSROOM (2) + 3 SPACES = 7 SPACES (2) = 1 SPACE PER 40 SQM (2) = 1 SPACE

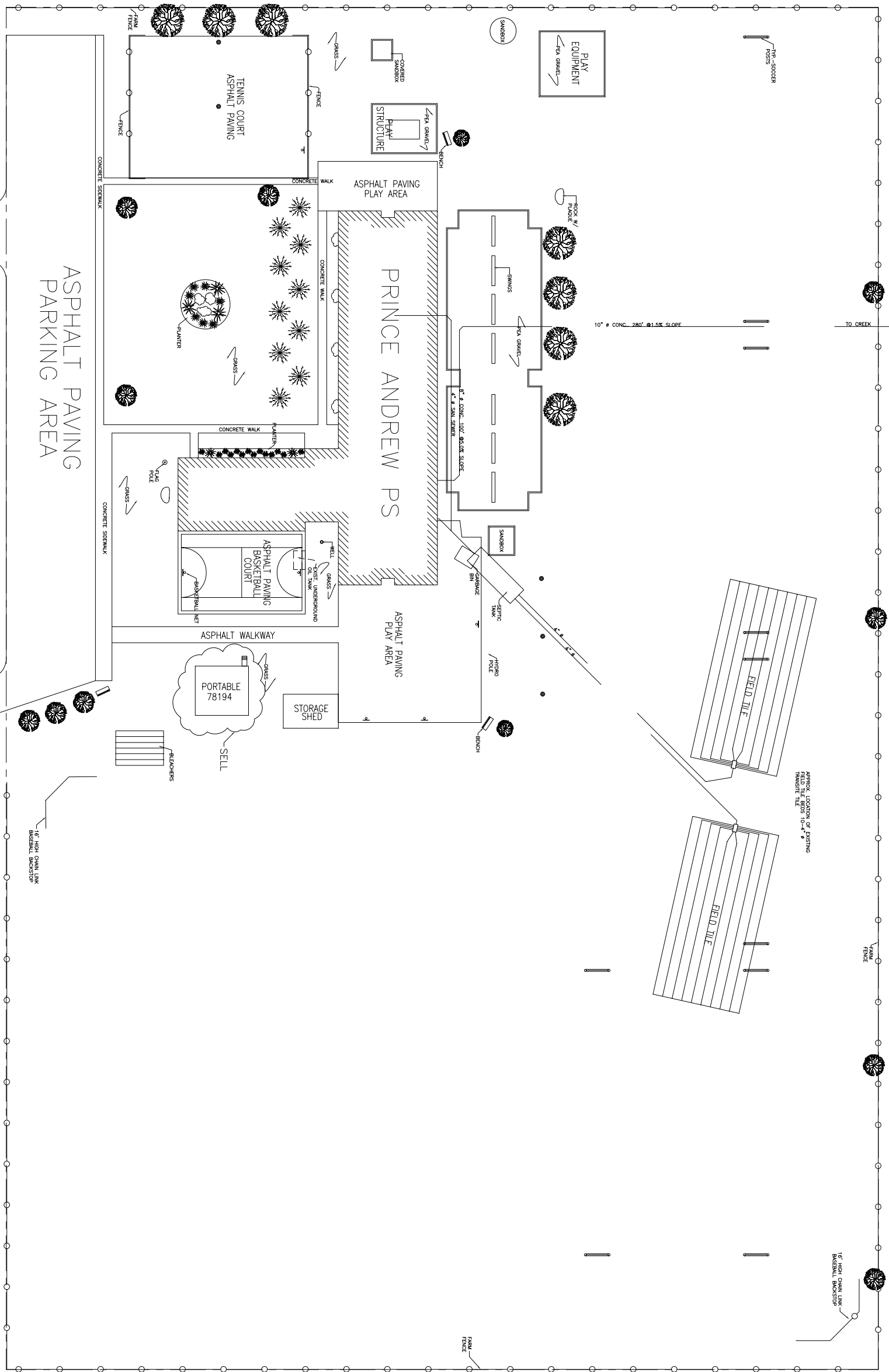

13 MILE ROAD

ASPHALT PAVING  
PARKING AREA

**PROJECT TITLE:**  
PRINCE ANDREW P.S.  
15237 THIRTEEN MILE ROAD, RR#4  
DENFIELD, ON  
1545

**PLOT PLAN**

DATE:	29/08/09	SCALE:	N.T.S.	SHEET NO.	11
DRAWN:	AS	CHECKED BY:	AS	FILE NAME:	1545-A1-1-09